

## EDM Wire Spool Size Chart

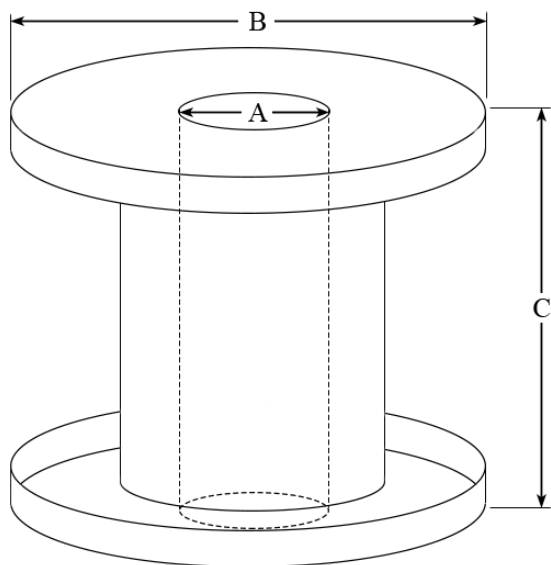

This guide is to help you figure out what type of wire you are currently using on your EDM machines. Use the measurements from your current spool to match them to the table below in order to find the spool size right for you. Depending on the sizes you may be able to use a smaller or larger size spool on your machines.

This is completely up to you and you should always follow the limitations set in the EDM machine's user manual for proper spool sizes for your machine.

Spool Type	A		B		C		Weight	
	mm	inches	mm	inches	mm	inches		
D-100	16	0.63	101.6	4	101.6	4	3.5 kg	7.7#
D-125	16	0.63	127	6.3	127	5	4 kg	8.8#
D-160	22	0.87	160	6.30	160	6.30	8 kg	17.6#
D-200	22	0.87	200	7.87	200	7.87	15 kg/16 kg	33# / 35.2#
DIN-250	36	1.34	250	9.84	200	7.87	25 kg	55#
P-3R	20	0.79	130	5.11	110	4.33	3kg	6.6#
P-5R	20	0.79	160	6.30	114	4.49	5 kg	11#
P-5	20	0.79	160	6.30	114	4.49	6 kg	13.2#
P-10	30	1.18	200	7.87	134	5.27	10 kg	22#
P-15 / P-15M / P-15L	34	1.34	250	9.84	140	5.51	20 kg	44#

We offer the highest quality EDM products for less. All products guaranteed to be OEM quality or better.

**EDMStore.com**  
**support@edmstore.com**  
**(336)757-8569**  
**www.edmstore.com**



Authorized  
**ProSource EDM Vendor**